

# MOSS BAY BUILDING

First floor, 4,514 SF flex/industrial space available  
– steps from Downtown Kirkland.



1015 7<sup>TH</sup> AVENUE, KIRKLAND, WA 98033

**ERNIE VELTON**  
(425) 985-7573  
erniev@jshproperties.com

**REESE VELTON**  
(425) 894-6555  
reesev@jshproperties.com

# Site Plan

## Flexible Workspaces in the Heart of Kirkland

The Moss Bay Building offers highly versatile flex/industrial suites with private offices, shop space, and restrooms—perfect for automotive, light industrial, and early-stage companies. Located at 1015 7th Avenue, Kirkland, this first-floor space sits directly on the Cross Kirkland Corridor Trail and is within walking

distance of Downtown Kirkland's shops, restaurants, and Google's Kirkland campus. Quick access to I-405, marked parking stalls, and nearby amenities like Kirkland Urban, Marina Park Pavilion, and Costco make this an exceptional business location.



AVAILABLE	SF	BASE RENT	NNN	COMMENTS
SUITE 140	4,514	\$25.00/SF	\$5.00/SF	Loading Dock, Reception, Restroom

CROSS KIRKLAND CORRIDOR TRAIL

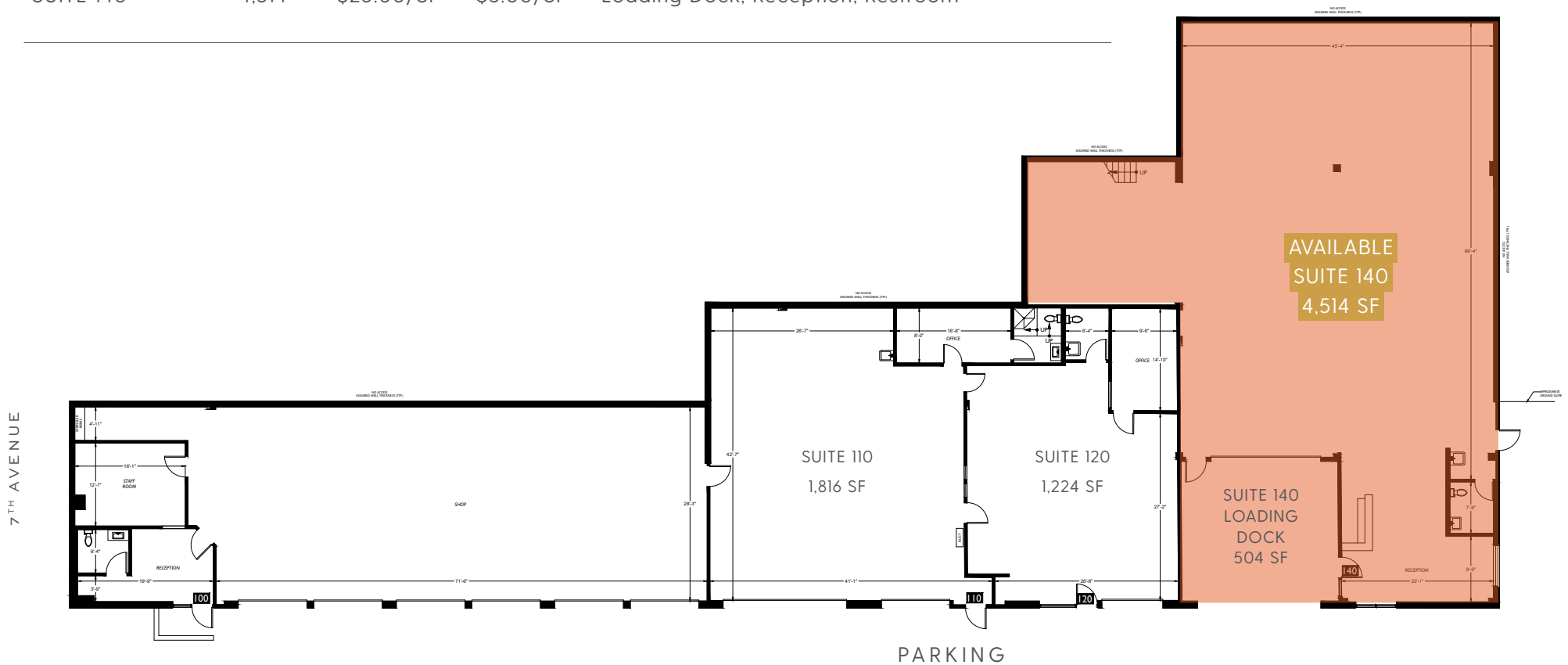

# Downtown Kirkland

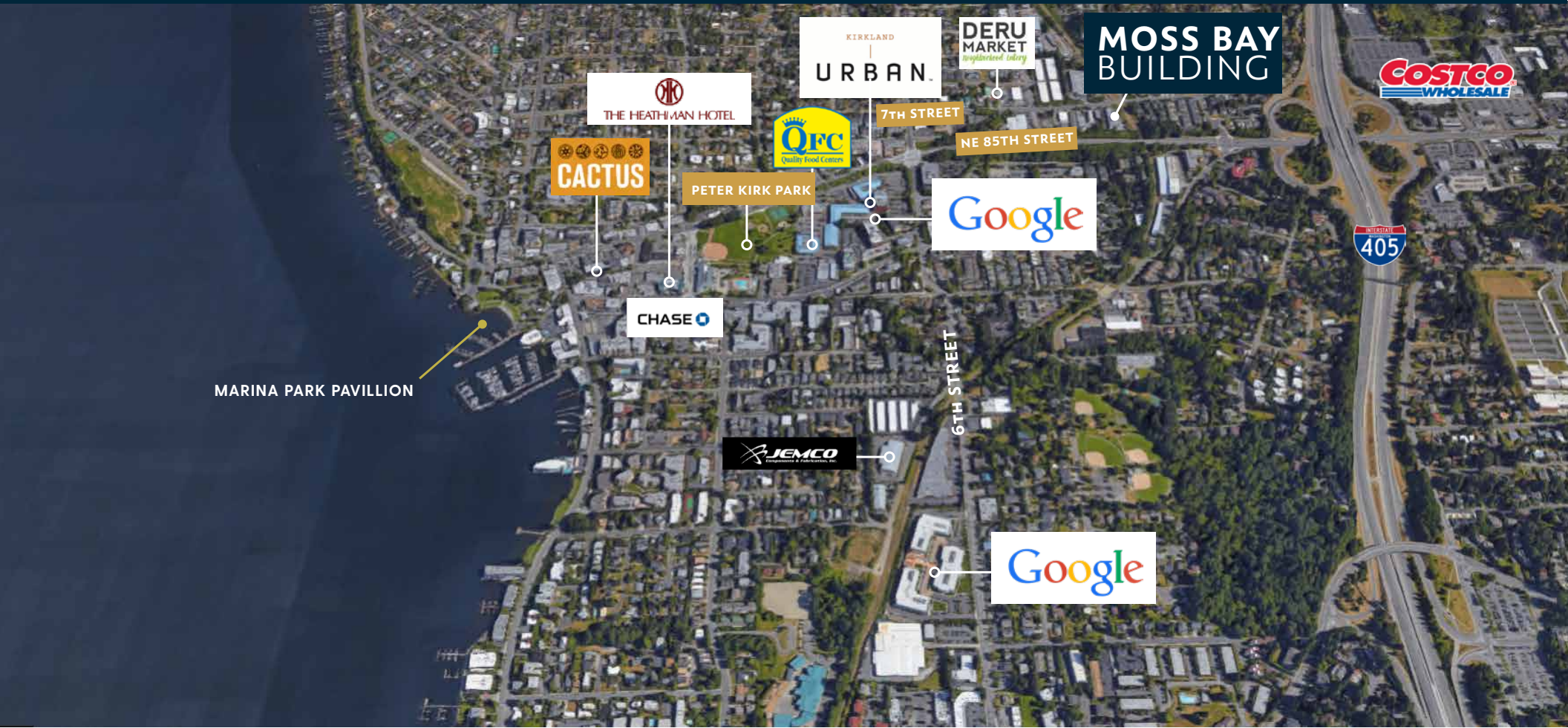

# Aerial



AVAILABLE  
SUITE 140  
4,514 SF