



5506 HATHAWAY BUILDING

Private Office In Georgetown Design District

876 SF / Kitchenette + Private Restroom

Perfect for 3–6 person teams ready to move into a private, professional space.

- Fully private office – no shared workspace
- In-suite kitchenette + private restroom (rare for this size)
- Open layout fits 4–6 desks comfortably
- Access to building conference room + fitness center
- Available Now – schedule a tour

Ideal for:

- Design firms & architects
- Small professional teams



5506 Sixth Avenue S Seattle WA 98108

OWNER/AGENT
STEVE HANSEN

425.283.5450

steveh@jshproperties.com

BROKER
WILL MUELLER

206.600.3589

willm@jshproperties.com



JSH | PROPERTIES, INC.

Flexible layout designed for small teams.

AVAILABLE	RSF	BASE RENT	NNN	
SUITE 107	876	\$26.00/SF	\$10.13	Private restroom + kitchenette included 4-6 workstations Small meeting / collaboration area Storage or breakout space

South Lucile Street

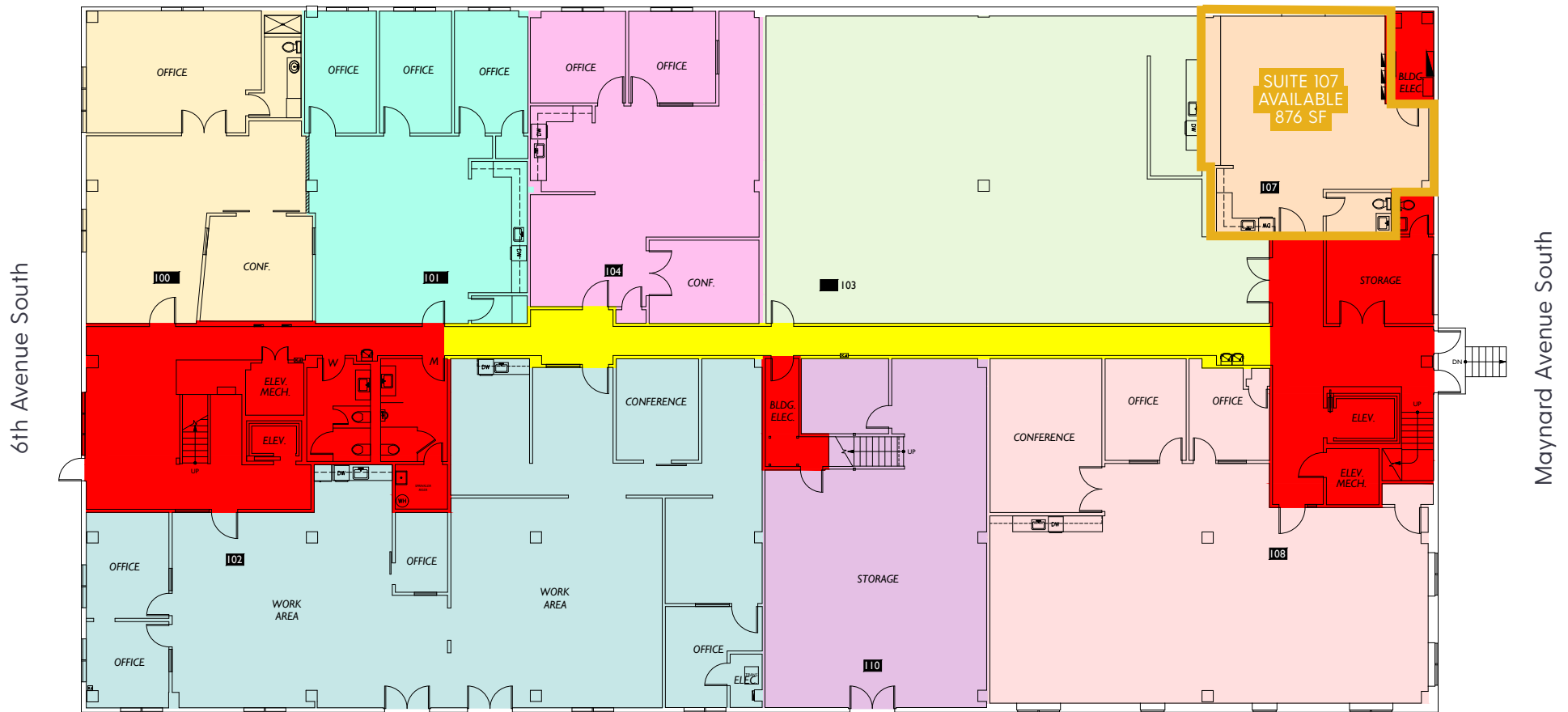

A Private, Functional Workspace That Works for Your Team

Open layout for flexible team setup



Natural light near work areas



Room for small collaboration area



Private kitchenette



Private restroom



Room for multiple desk work areas



Amenities That Extend Your Workspace



HATHAWAY CONFERENCE ROOM

Conference room access
for client meetings and team collaboration



On-site fitness room
for employee convenience and wellness

HATHAWAY FITNESS ROOM



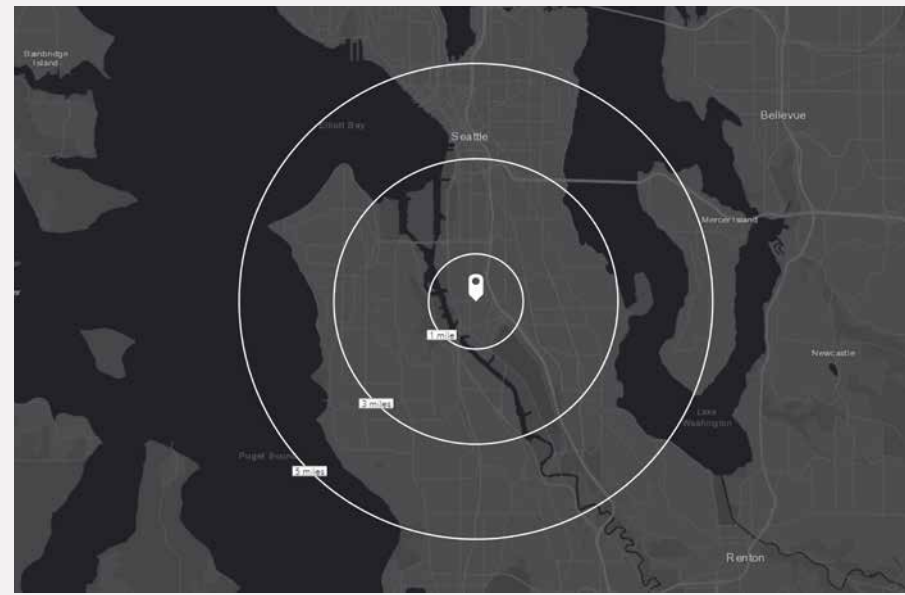

HATHAWAY BUILDING is located in the heart of the Design District in Georgetown, just south of Downtown Seattle, and within a few blocks of Georgetown Squared, Seattle Design Center, USPS, Daltile, & McKinstry.

Interior designers, artists, workrooms, and architects enjoy convenient access to international architectural design brands such as Trammell-Gagne, and Jennifer West. Georgetown's Art Walk happens every second Saturday of the year.

Quick access to I-5 and Highway 99. Offering surface lot and street parking, the Hathaway Building is located within walking distance to several lunch hot spots and is a ten minute drive or bus ride to Downtown Seattle and Boeing.



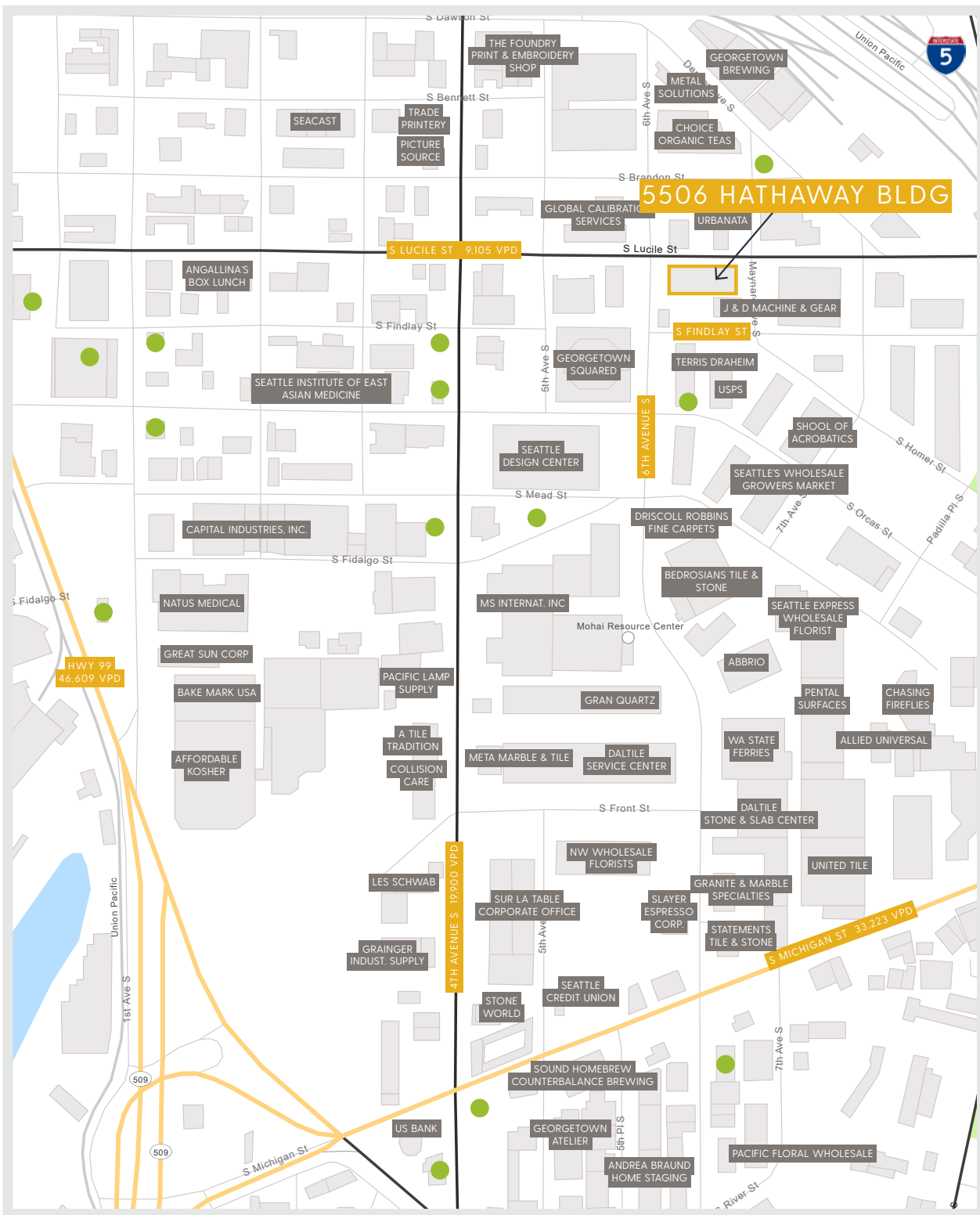

COFFEE

ESPRESSO BY DESIGN
 BROTHER JOE
 ALL CITY COFFEE
 FRAN'S CHOCOLATES
 LADY BUG ESPRESSO
 STARBUCKS
 HANGAR CAFE
 FIVE HORIZONS ESPRESSO
 CAFETAL QUILOMBO CAFE
 PORTSIDE COFFEE COMPANY
 CAVU CAFE
 BARES AND WATSON FINE TEAS
 RAINIER COMMONS

RESTAURANTS

CONSCIOUS EATERY
 NAKAYAMA SALES
 LECT'S SOUP SHOP
 THE BLU GROUSE
 URBAN CHICKENS
 PHO SRIRACHA
 SUBWAY
 MARCO POLO BAR & GRILL
 THE DOG HOUSE BAR & GRILL
 LUCKY CHINESE RESTAURANT
 CUTTING BOARD
 STELLAR PIZZA, ALE & COCKTAILS
 PIG IRON BBQ
 SLIM'S LAST CHANCE

Located just minutes south of Downtown Seattle, Georgetown's lively cultural community is home to over 40 galleries, diners, nightclubs, coffee houses, art studios, bookstores and more.

Every second Saturday visitors attend the Georgetown's Art Walk "Art Attack" featuring over 20 local artists venues.

- 1 Equinox Outpost
 - A. Seattle Artist League
 - B. Rose/Ferrell Studio
- 2 studio e gallery
- 3 Scarlet Ibis
- 4 Friends of SPL/Unique Art Glass
- 5 Unexpected Productions
- 6 Side Rail Collective
- 7 Fogue Studios & Gallery
- 8 Seattle Art Source
- 9 Post Pike
- 10 Georgetown Trailer Park Mall
- 11 Neil Kelly
- 12 El Sirenito
- 13 Jules Maes Saloon
- 14 Tinte Cellars
- 15 Prairie Underground
- 16 All City Coffee
- 17 Fantagraphics Bookstore & Gallery
- 18 SlipStitch
- 19 Deep Sea Sugar & Salt
- 20 Badger Burrow Studios
- 21 Eight Roses Gallery
- 22 Mini Mart City Park
- 23 6-Arts
- 24 Equinox Studios
- 25 The Reef Georgetown



HATHAWAY BUILDING | OFFICE AVAILABLE FOR LEASE

JSHPROPERTIES.COM