

BELLEVUE RETAIL AVAILABLE

Bel-East Shopping Center

1504 145TH PLACE SE | BELLEVUE, WA 98007

Within two miles of
Microsoft Headquarters,
& Downtown Bellevue.
Anchored by QFC.

ADDRESS

1504 145th Place SE
Bellevue, WA 98007

ASKING RENT

\$34.00psf/yr + \$9.40psf/yr NNN
(NO FOOD, SALON OR MASSAGE USES)

AVAILABLE

- 1,445 SF ENDCAP AVAILABLE*
*with 30-day notice.
- Landlord is providing time for plans, permits and construction.
- QFC-Anchored neighborhood center with excellent visibility.
- Strong demographics in high traffic area.

VEHICLES PER DAY

15,320 (145TH PL SE)

ERNIE VELTON

erniev@jshproperties.com

REESE VELTON

reesev@jshproperties.com

425.455.0500



BEL-EAST

SHOPPING CENTER

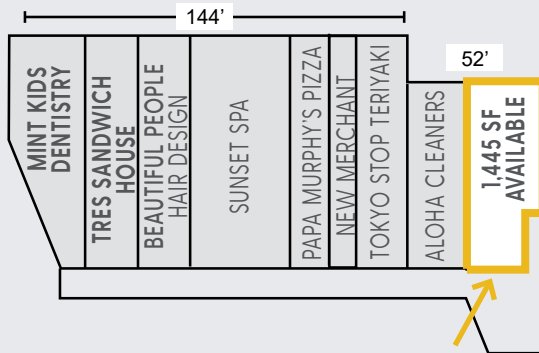

1,445 SF
RETAIL SPACES AVAILABLE
\$34.00 PSF/YR + \$9.40 NNN PSF/YR
(NO FOOD, SALON OR MASSAGE USES)



BEL-EAST

SHOPPING CENTER

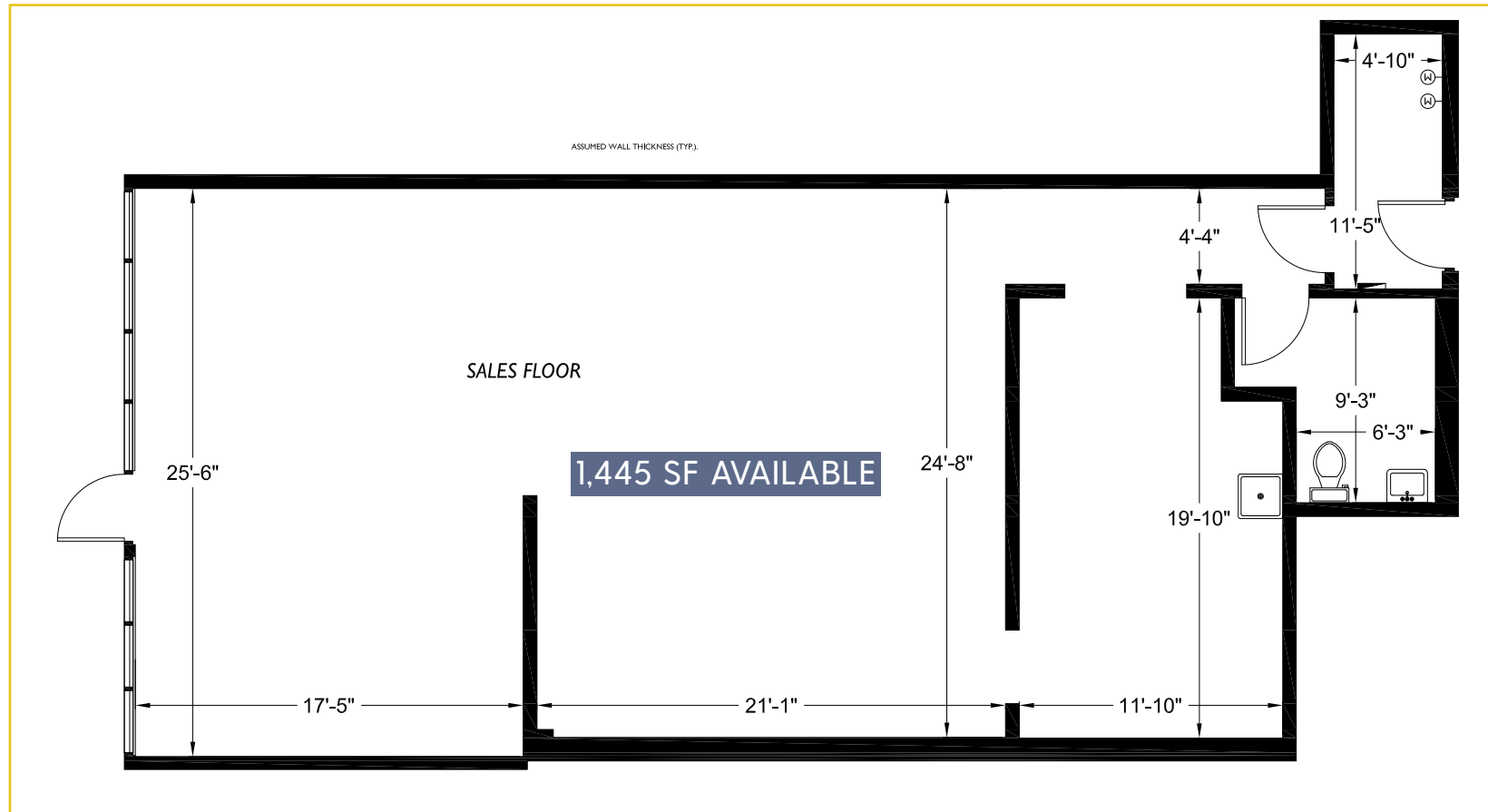

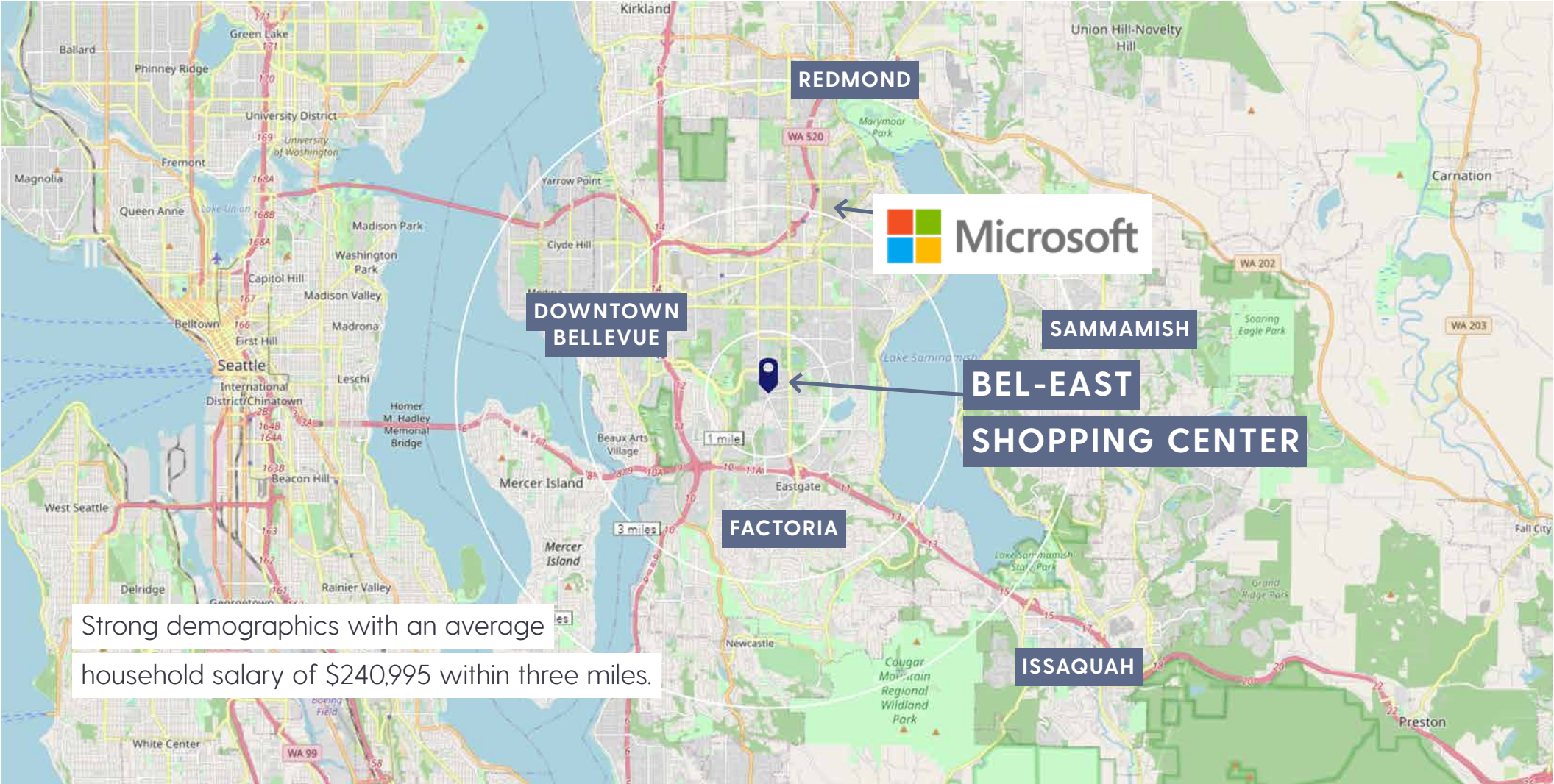

2025 DEMOGRAPHICS

	1 MILE	3 MILE	5 MILE
Population	14,955	123,787	251,343
Daytime Population	14,439	191,625	320,629
Households	5,382	51,632	99,166
Avg. Household Income	\$220,578	\$240,995	\$265,681



BEL EAST SHOPPING CENTER RETAIL AVAILABLE | 4 |