

# AMLI WALLINGFORD

2,012 SF Retail/Restaurant  
Fremont / Wallingford - 1853 N 34<sup>th</sup> Street, Seattle

2,012 SF  
RETAIL / RESTAURANT  
TYPE 1 VENTING  
\$35.00/SF, NNN



# AMLI WALLINGFORD

2,012 SF Retail/Restaurant  
Fremont / Wallingford - 1853 N 34<sup>th</sup> Street, Seattle





# AMLI WALLINGFORD

2,012 SF Retail/Restaurant  
Fremont / Wallingford - 1853 N 34<sup>th</sup> Street, Seattle



2,012 SF  
RETAIL / RESTAURANT  
\$35.00/SF, NNN



### NORTH 34<sup>TH</sup> STREET

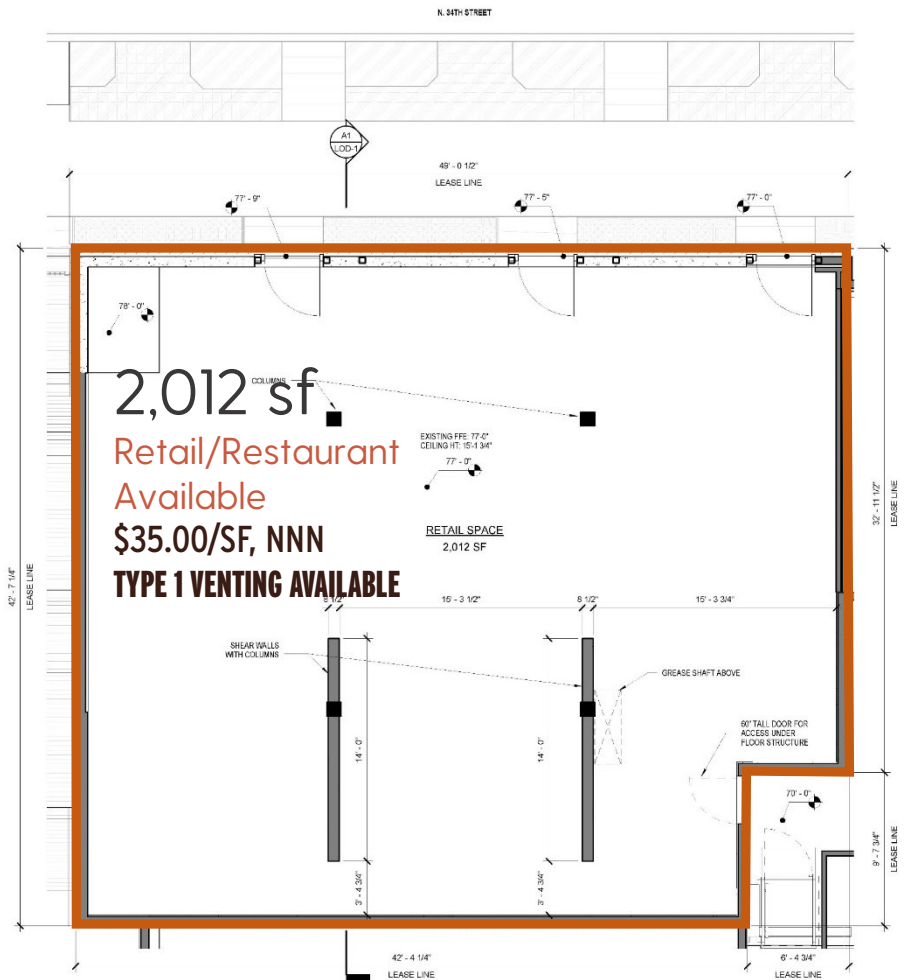

Part of 231-unit mixed use residential property,  
2,012 sf ground floor retail/restaurant steps from Gas Works  
park, Burke Gilman Trail, and the Fremont Business District.

