



100% LEASED!

Freeway X

18505 Alderwood Mall Pkwy | Lynnwood, WA 98037

Contact: Steven E. Olsen
425.455.0500 | steveo@jshproperties.com

 JSH | PROPERTIES, INC.

425.455.0500 | JSHPROPERTIES.COM

NEW
TENANT
OPENING
SOON!

17,010 Cars Per Day - 184th St SW

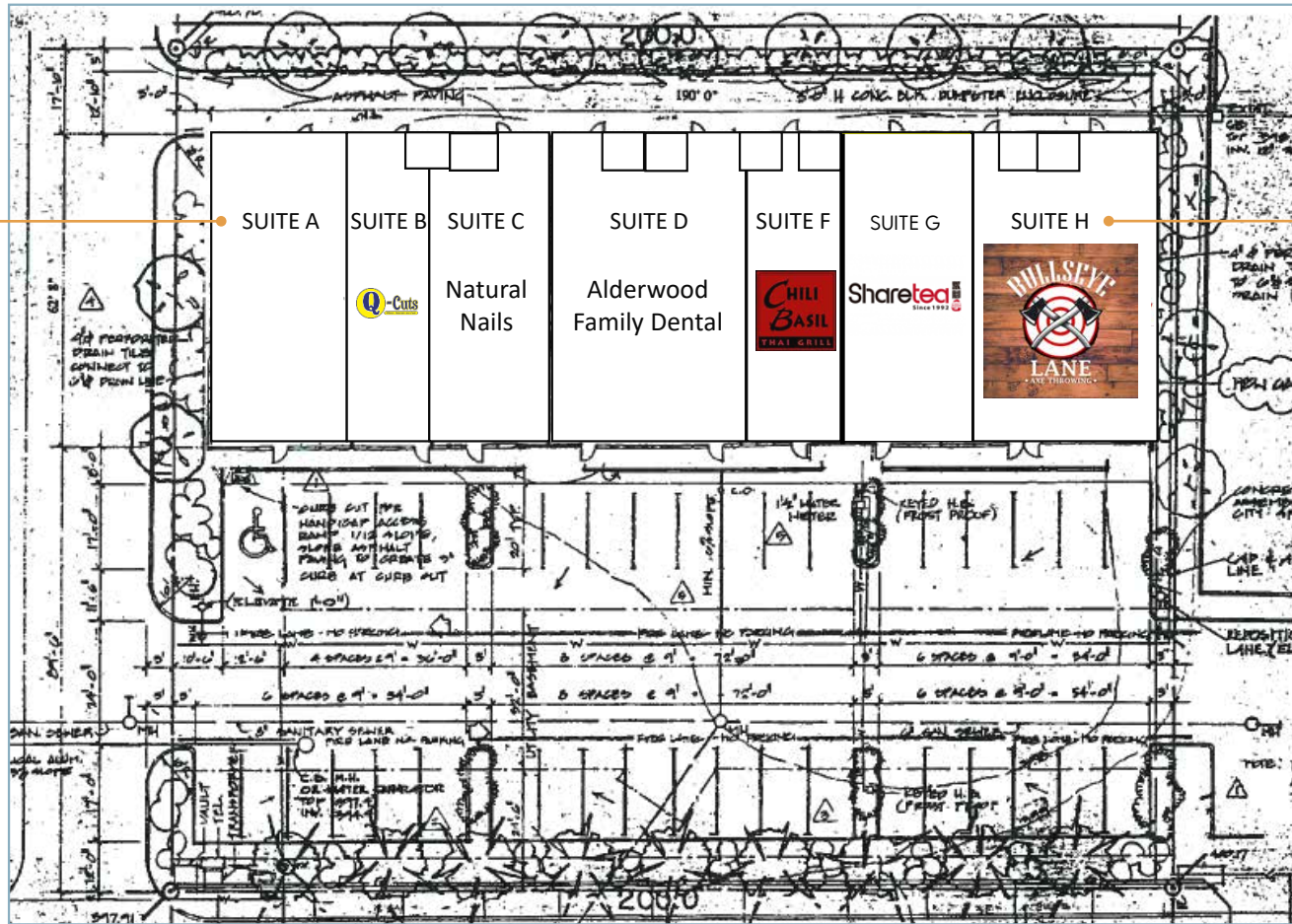

BULLSEYE
LANE
AXE
THROWING!

Alderwood Mall Parkway - 28,310 Cars Per Day





Freeway X is conveniently located next to Alderwood Mall, Snohomish County's largest shopping mall positioned at the busy bisection of I-405 and I-5 in Lynnwood. This growing area is home to Lynnwood's retail, restaurant and entertainment epicenter.

- ● ● ● ● ALDERWOOD MALL PKWY - 28,310 VPD
- ● ● ● ● 184TH ST SW - 17,010 VPD



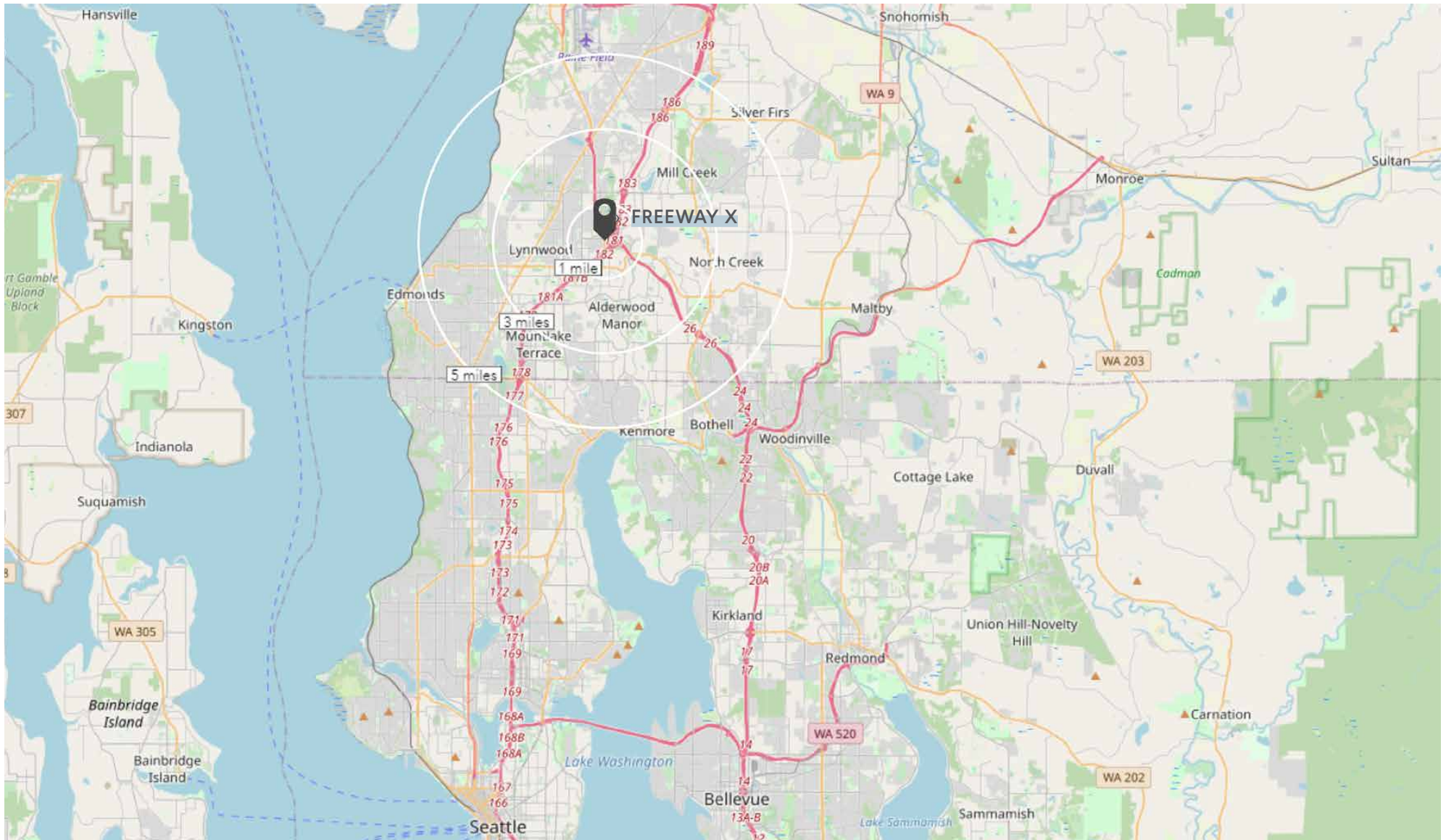

2022 DEMOGRAPHICS

	<i>1 MILE</i>	<i>3 MILE</i>	<i>5 MILE</i>
Population	10,915	154,676	368,187
Daytime Population	16,392	128,081	303,280
Avg. Household Income	\$114,322	\$122,336	\$136,469

- » South and North end-cap spaces!
- » Close to Target, Khol's, and Alderwood Mall
- » \$105,092 Average Household Income



KEY FACTS



368,187

Population



38.5

Median Age



2.6

Average Household Size



\$136,469

2022 Average Household Income (Esri)

EMPLOYMENT



71%

White Collar



18%

Blue Collar



11%

Services

KEY FACTS

368,187

Population



2.6

Average Household Size



38.5

Median Age

\$103,403

Median Household Income



6%

No High School Diploma



18%

High School Graduate



31%

Some College



45%

Bachelor's/Grad/Prof Degree

EDUCATION

BUSINESS



9,169

Total Businesses



98,106

Total Employees



\$3,779

Travel



\$138

Movies/Museums/Parks



\$747,559,846

2022 Meals at Restaurants/Other

ANNUAL LIFESTYLE SPENDING