

# NORTH CREEK COMMERCE CENTER

A 250,000 square foot,  
brand new flex / industrial  
park for lease in Bothell

18712 BOTHELL-EVERETT HWY, BOTHELL, WA



DEVELOPED BY

 PANATTONI®

REPRESENTED BY

 JSH | PROPERTIES, INC.

 **Kidder  
Mathews**

# NORTH CREEK COMMERCE CENTER



Space available for lease in a 250,000 SF, brand new class-A flex / industrial park

BLDG B  
96,000 SF

BLDG A  
124,500 SF

BLDG C  
29,000 SF



JSH | PROPERTIES, INC.



Kidder  
Mathews

## Property Overview

**250,000 SF**

TOTAL

**124,500 SF**

BUILDING A

**96,000 SF**

BUILDING B

**29,000 SF**

BUILDING C



**2023 CONSTRUCTION  
DELIVERY Q4 2023**



**2.5 STALLS / 1,000 SF  
PARKING RATIO**



**30' CLEAR HEIGHT**



**DOCK / GRADE LEVEL  
LOADING WITH 130'  
DEDICATED TRUCK COURT**



**HEAVY POWER  
AVAILABLE**



**CALL AGENTS  
FOR LEASE RATES**

NORTH CREEK  
COMMERCE CENTER

Site Plan

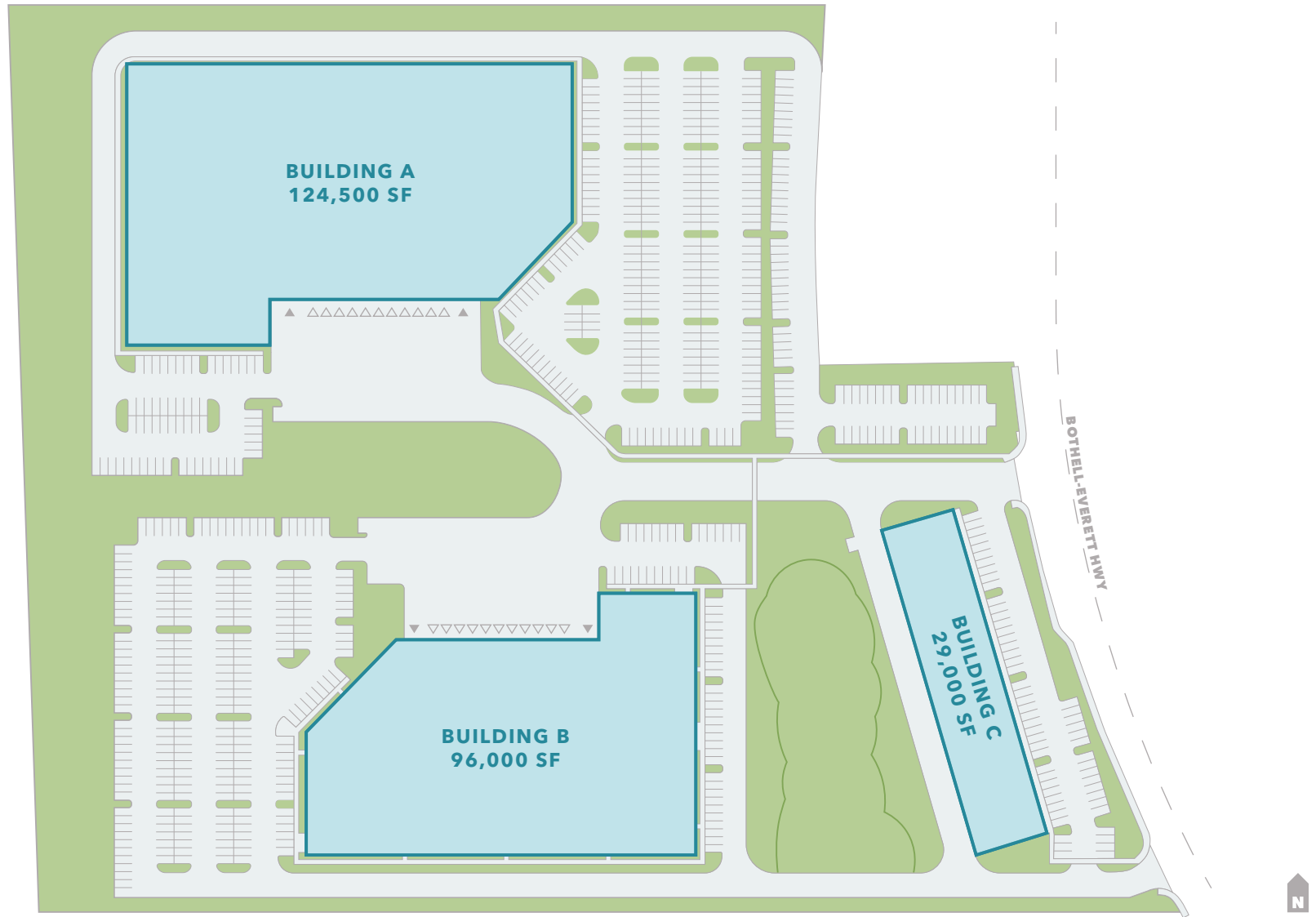

▲ DRIVE-IN  
DOORS

△ DOCK-HIGH  
DOORS

JSH | PROPERTIES, INC.

km Kidder  
Mathews

# Building A

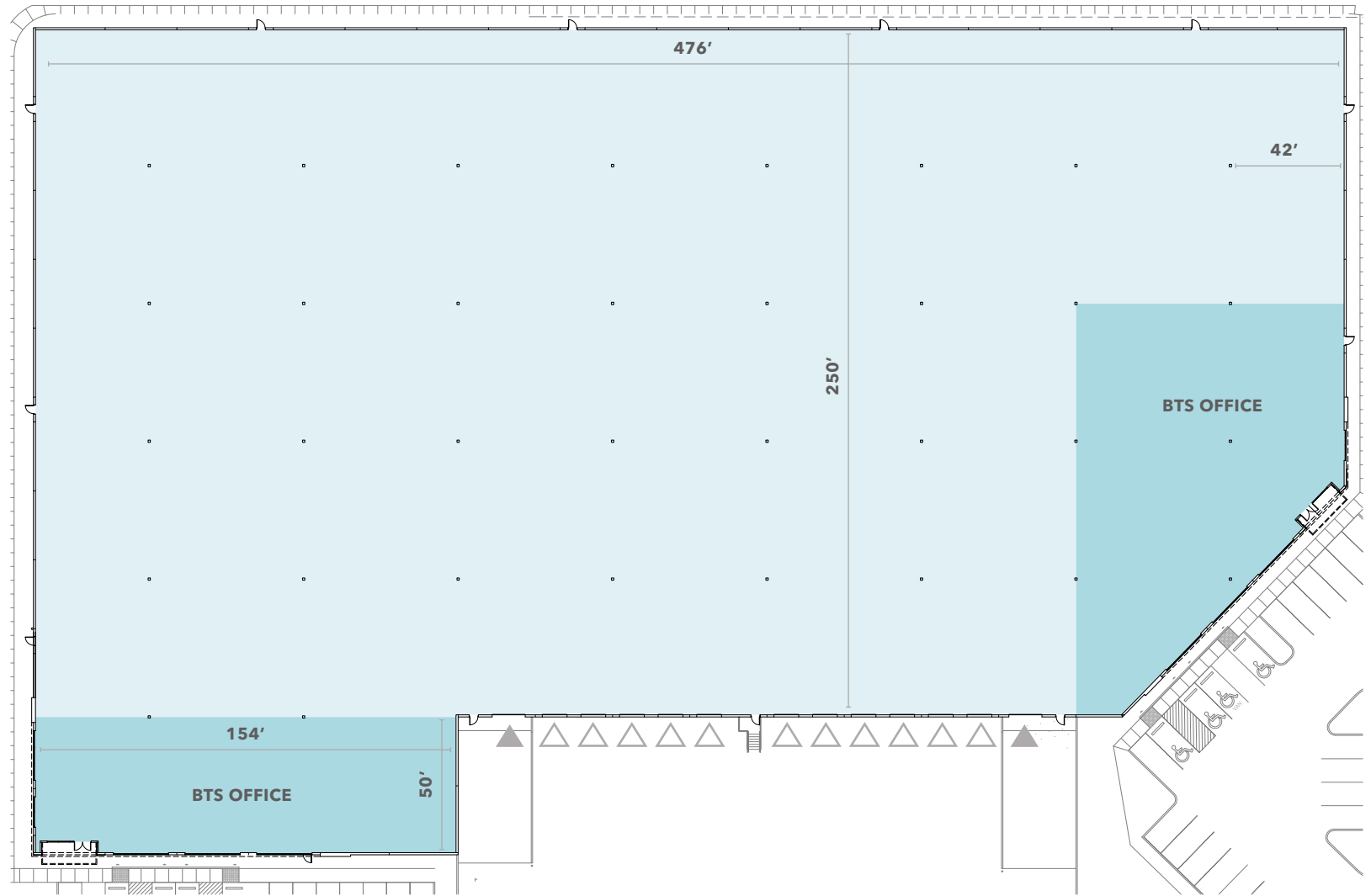

# Building B

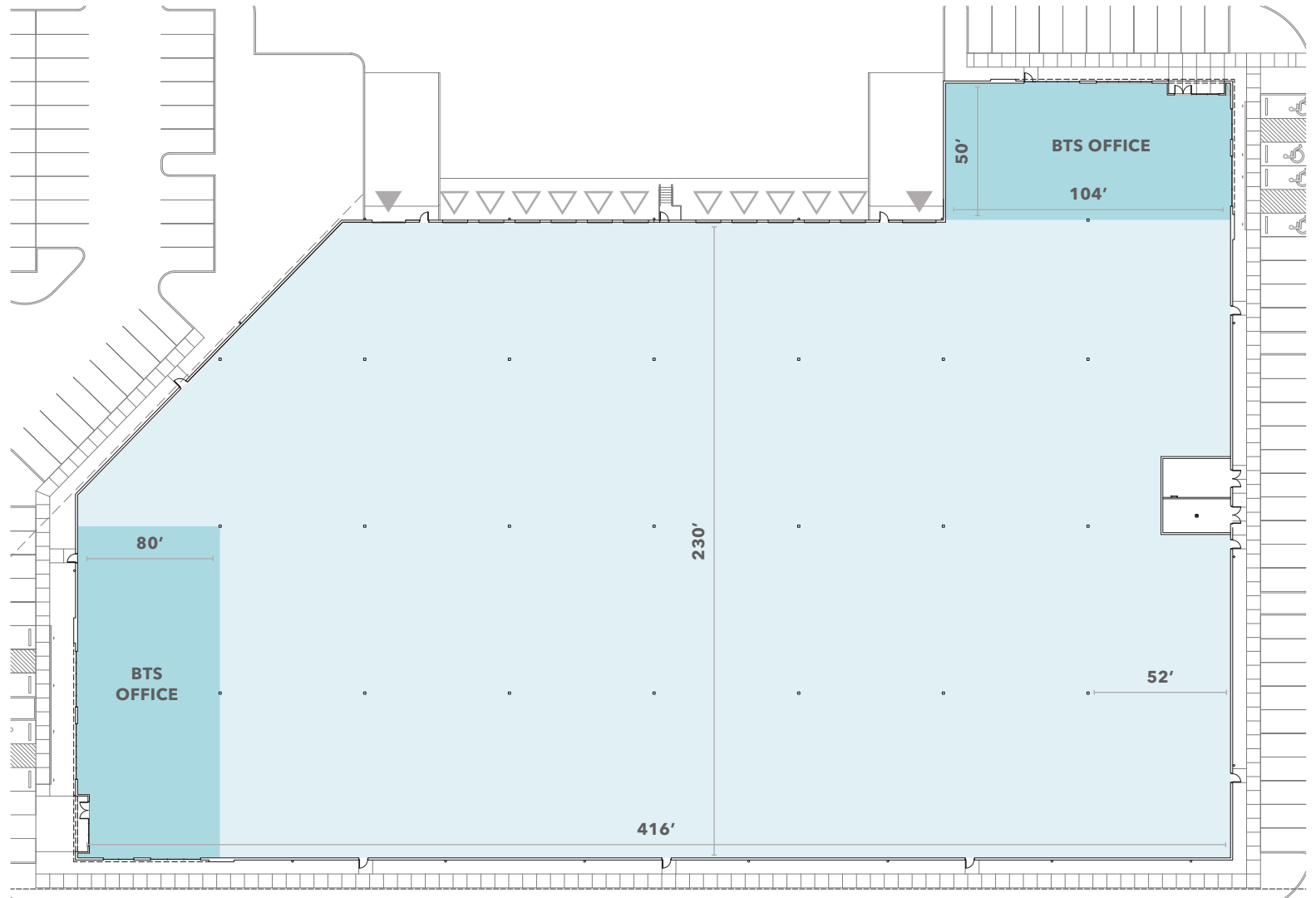

# Building C

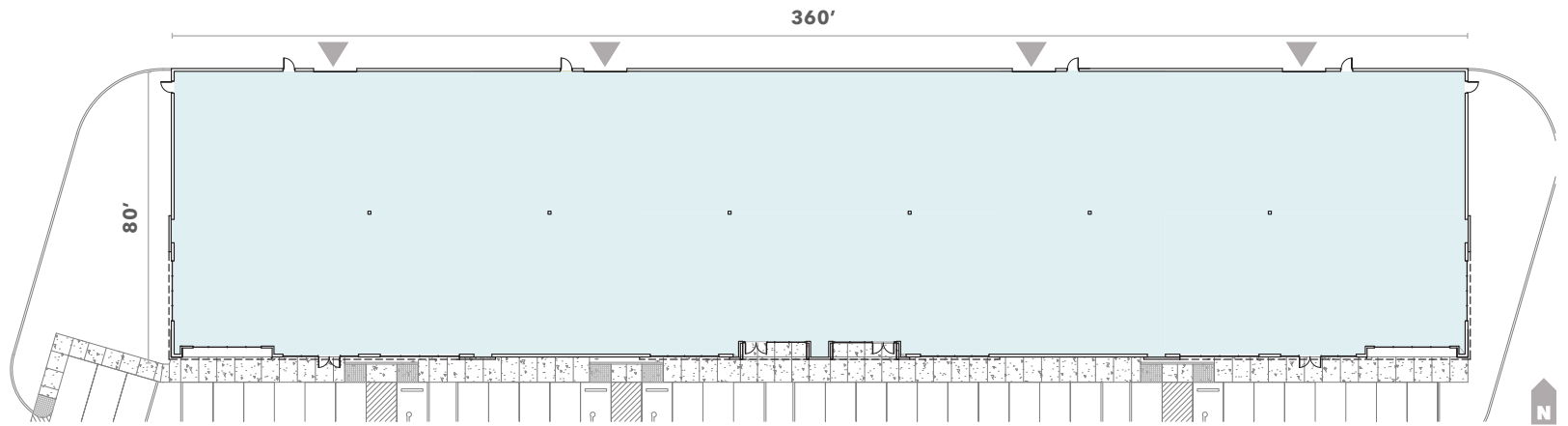

## ELEVATIONS



WAREHOUSE OFFICE

# NORTH CREEK COMMERCE CENTER



Perfectly connected with easy access to major freeways and interstate highways

2.5 MI

TO I-405

3.4 MI

TO I-5

4.7 MI

TO SR-9

NORTH CREEK  
COMMERCE CTR

8 MIN TO I-5

9 MIN TO SR-9

6 MIN TO I-405



JSH | PROPERTIES, INC.



Kidder  
Mathews



# NORTH CREEK COMMERCE CENTER

18712 BOTHELL-EVERETT HWY  
BOTHELL, WA



## For leasing information contact

### ZACH VALL-SPINOSA

Kidder Mathews  
425.450.1115  
zach.vallspinosa@kidder.com

### ERNIE VELTON

JSH Properties  
425.283.5471  
erniev@jshproperties.com

### REESE VELTON

JSH Properties  
425.283.5484  
reesev@jshproperties.com

## DEVELOPED BY



## REPRESENTED BY



This information supplied herein is from sources we deem reliable. It is provided without any representation, warranty, or guarantee, expressed or implied as to its accuracy. Prospective Buyer or Tenant should conduct an independent investigation and verification of all matters deemed to be material, including, but not limited to, statements of income and expenses. Consult your attorney, accountant, or other professional advisor.