

FOR LEASE

DELIVERY: Q1 2023

RETAIL B
3,953 SF
Retail or Service

RETAIL A
4,767 SF Corner Space
Restaurant or Retail
CAN BE DEMISED
DEMISING PLAN ON PAGE 6

QUEEN ANNE AVE N

HARRISON STREET

400 QUEEN ANNE AVE N
SEATTLE, WA 98109

JOHN CHELICO
206.859.4500
johnc@jshproperties.com



400 Queen Anne Ave N

RETAIL AVAILABLE

RETAIL A ~ 4,767 SF CAN BE DEMISED. (Prime corner at intersection, Type 1 hood)

RETAIL B ~ 3,953 SF (next to residential entrance)

Call for pricing. Project Completion: Q1 2023

NNN Estimated at \$11.00 psf/yr

PROPERTY

8 Floors, 143 Residential Units

27 Commercial Parking Stalls

The Neighborhood

- Prime ground floor retail directly on Queen Anne Ave N and Harrison Street, below 143 new high-end apartment homes at 400 Queen Anne.
- One half block from Climate Change Arena, home of the Kracken and established headliner concert venue.
- Excellent visibility to Queen Anne Avenue N - the primary arterial to Mercer Street giving access to I-5 N & S.
- 11,705 cars per day pass the site (corner of Queen Anne Ave & Harrison St)
- 96 walkscore makes this an ideal area for pedestrian driven residential and daytime population retail
- Across the street from a proposed 8-story office building for development (401 Queen Anne Ave N).



VIEW FROM HARRISON



VIEW FROM QUEEN ANNE AVE N





QUEEN ANNE AVE N



HARRISON STREET

ENTRANCE

ENTRANCE

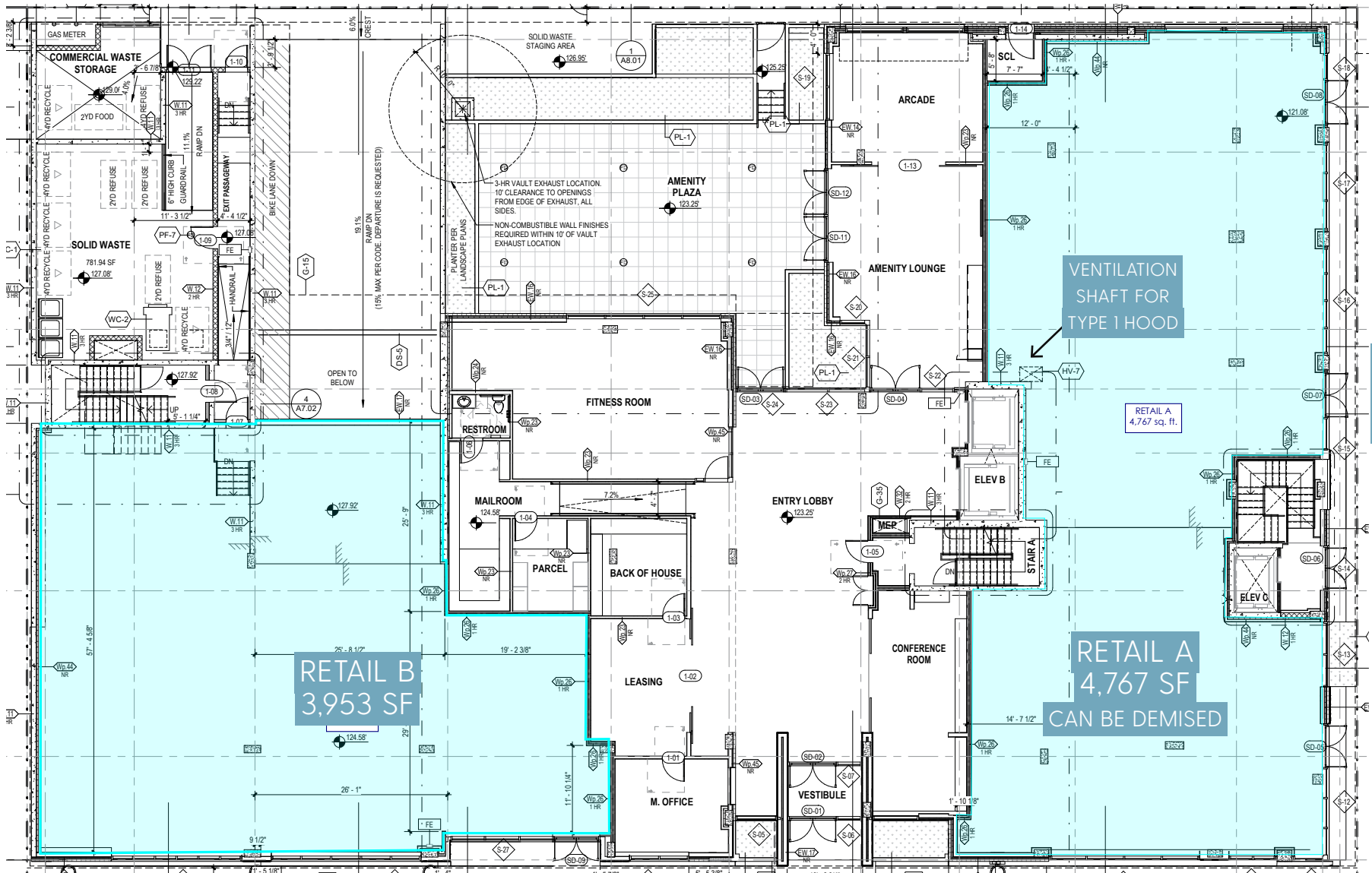

RETAIL B
3,953 SF

RETAIL A
4,767 SF
CAN BE DEMISED

VENTILATION
SHAFT FOR
TYPE I HOOD

QUEEN ANNE AVE N

ENTRANCE

RESIDENTIAL
ENTRANCE

CONTROLLED
INTERSECTION



DEMISING PLAN OPTIONS

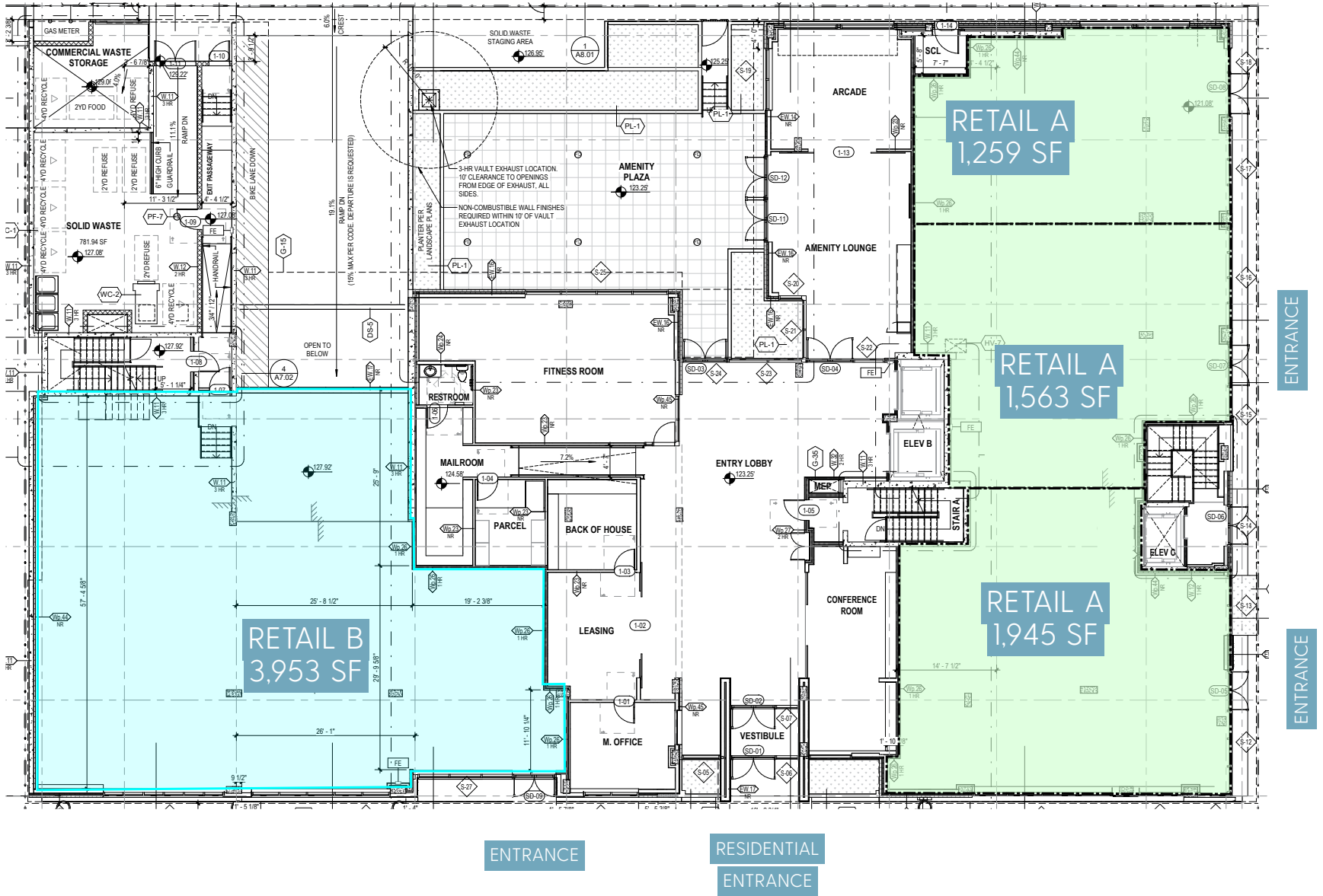

Uptown | The Neighborhood

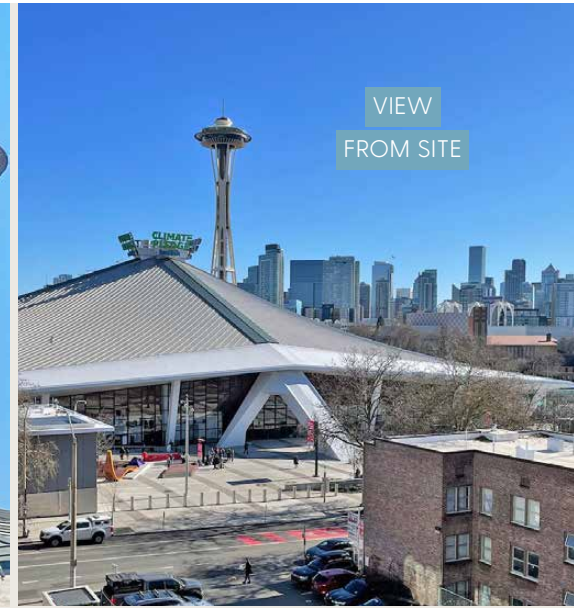

Located one block from Climate Pledge Arena, designed to hold up to 18,100 guests.
Scheduled to open October, 2021. Seattle Center serves over 12-million visitors each year.



Vehicles per Day
Queen Anne Ave N

9,450



Walker's
Paradise

96



Excellent
Transit

73



Very
Bikeable

81



Bachelor's
Degree or Higher

77%

2021 DEMOGRAPHICS

	0.5 MILE	1 MILE	3 MILE
Population	16,125	50,239	252,650
Daytime Population	22,788	72,408	392,977
Households	11,267	33,604	140,545
Avg. Household Income	\$148,115	\$157,885	\$146,866

THE INFORMATION CONTAINED HEREIN HAS BEEN GIVEN TO US BY SOURCES WE DEEM RELIABLE. WE HAVE NO REASON TO DOUBT ITS ACCURACY. BUT WE DO NOT GUARANTEE IT. ALL INFORMATION SHOULD BE VERIFIED PRIOR TO PURCHASE OR LEASE. SITE PLAN NOT TO SCALE. SITE PLAN AND TENANTS SUBJECT TO CHANGE.