

KIRKLAND RETAIL & RESTAURANT FOR LEASE

ESTIMATED DELIVERY: 4TH QUARTER 2022



LAKE STREET BUILDING

112 & 150 LAKE STREET, KIRKLAND, WA 98033

JOHN CHELICO

206.859.4500

johnc@jshproperties.com

 JSH | PROPERTIES, INC.

112 & 150

LAKE STREET, KIRKLAND WA

- Located at 112 and 150 Lake Street South in downtown Kirkland, Washington. The project is a 5-story mixed use building consisting of 141 new residential units, 13,098 square feet of retail space and 9,100 square feet of office space.
- Downtown Kirkland is a vibrant lakeside community that is just north of Bellevue, known for its waterfront parks, stunning views, art galleries, boutique shopping and dining. Based on census estimates, the City of Kirkland is home to 92,188 people making it the sixth largest city in King County and the thirteenth largest city in the State of Washington.
- Google has committed to 1,000,000 square feet of office space within walking distance of the Lake Street Building. Kirkland Urban is also home to Tableau Software who signed a lease for 92,000 square feet of office space. Lake Street is 6 miles from Downtown Bellevue, where over 4.9M square feet of new office space is being developed and leased to Amazon, which plans to bring 25,000 jobs to the Eastside of Lake Washington by 2025.





KIRKLAND, WA

LAKESIDE COMMUNITY



SUITE 112
5,100 SF

PUBLIC
PLAZA

SUITE 150
4,383 SF

AVAILABLE: 112 & 150

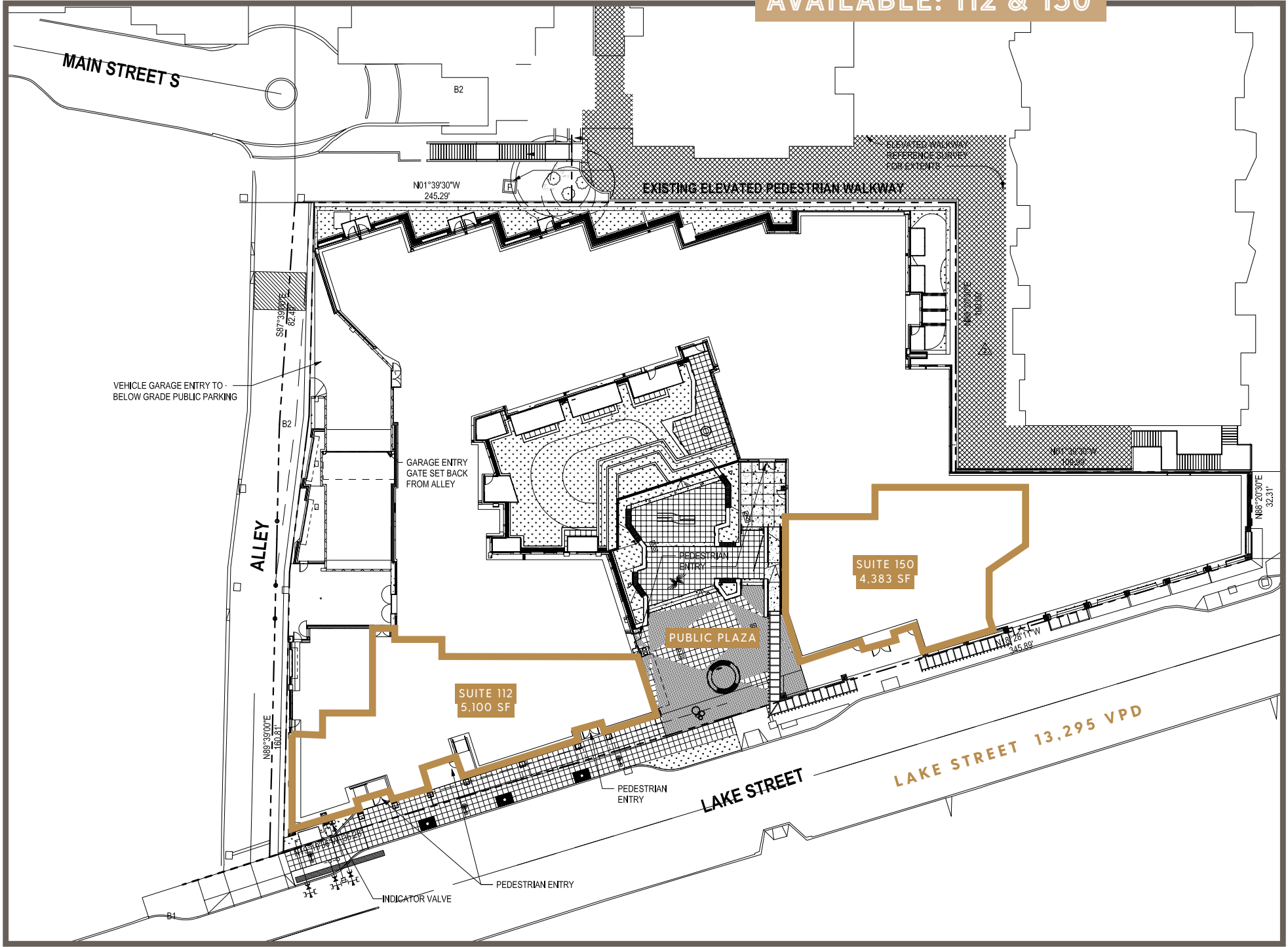

PUBLIC PLAZA



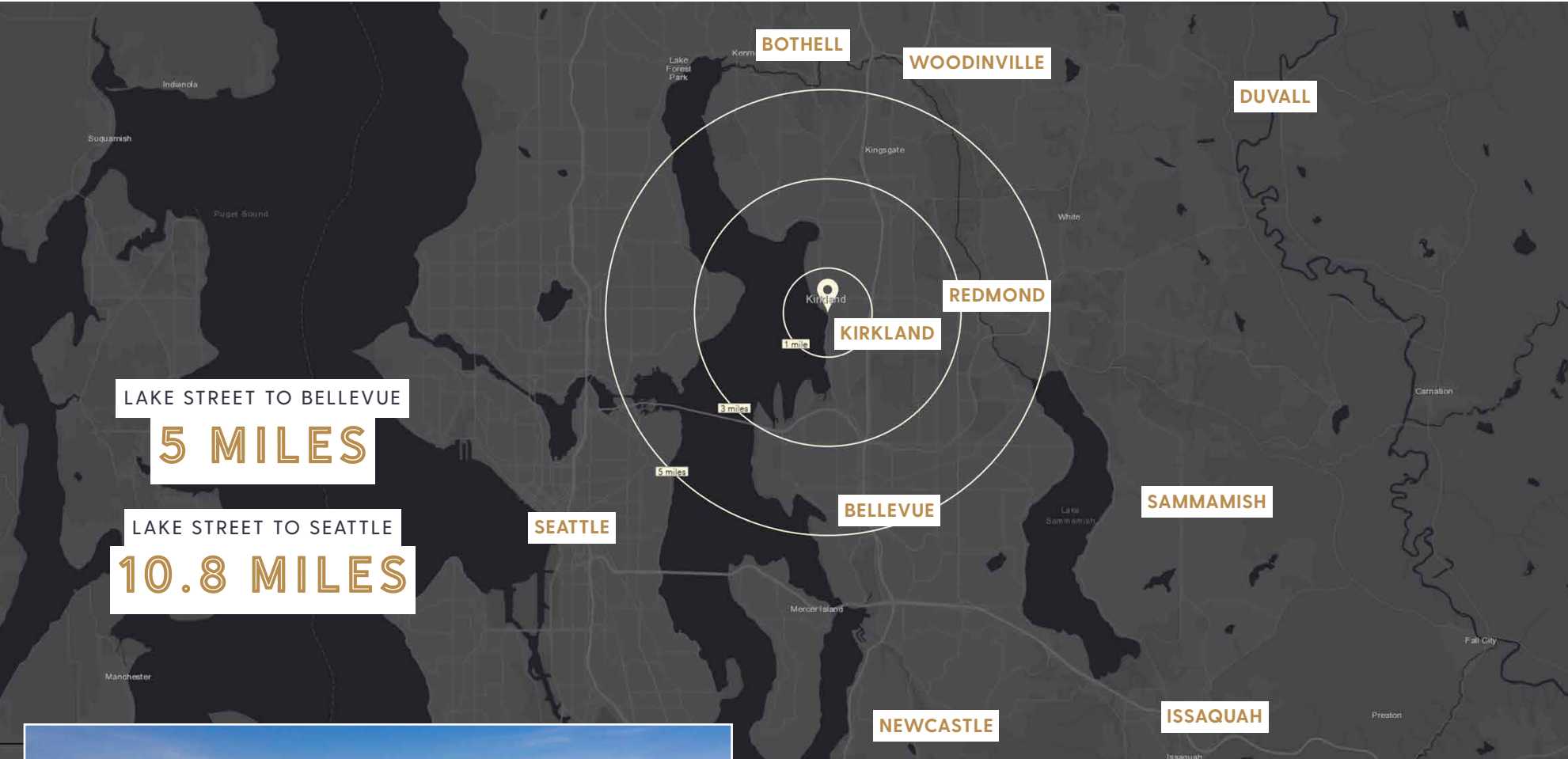

2021 DEMOGRAPHICS	1 MILE	3 MILES	5 MILES
POPULATION	13,740	81,942	309,757
DAYTIME POPULATION	17,648	89,749	372,374
HOUSEHOLDS	7,221	35,726	129,019
AVG. HH INCOME	\$178,444	\$181,896	\$175,617

